

AGES
6+



Read through this entire instruction manual BEFORE using **EscapeChopper 3D Wind Up Puzzle**.

Images may vary from actual product.



PROTOCOL

PARTS

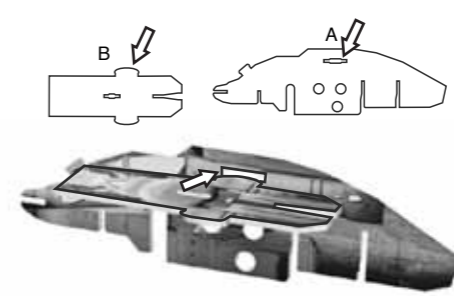
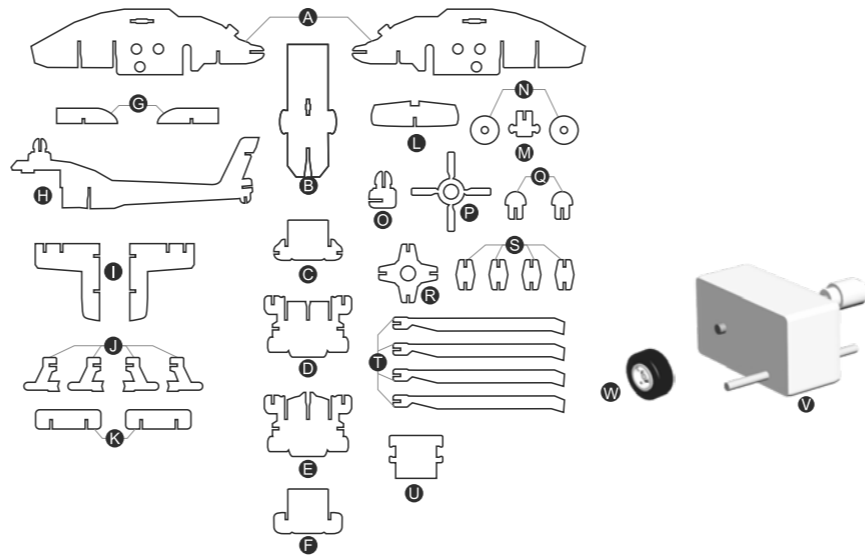

1 A+B

Attach piece B horizontally into one of the larger pieces (A).

Note: Make sure all pieces are pressed in all the way in order to securely interlock and leave room for later pieces.

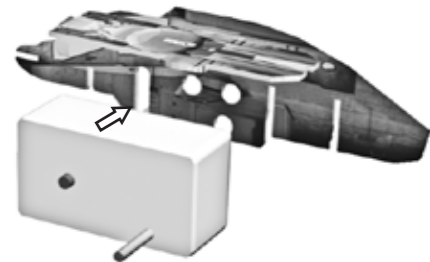

2 A+B+V

Attach motor by guiding the wind-up peg into the long vertical cutout on piece A.

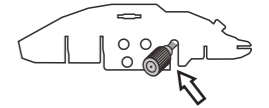

ASSEMBLY



5 +F

Attach the F piece to the front of the helicopter.

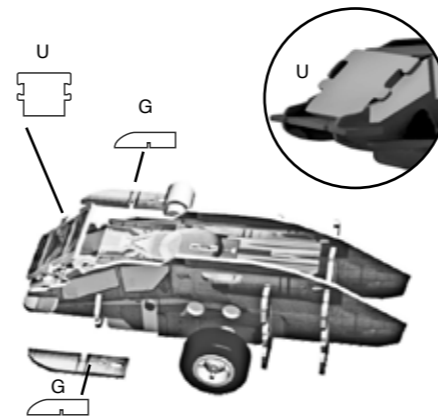

7 +G+U

Attach the windshield (U) and side plates (G).

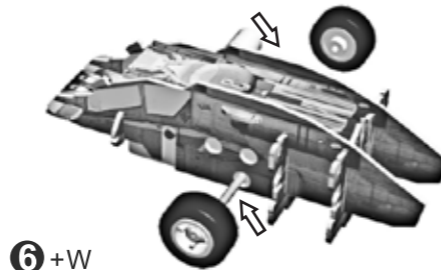

6 +W

Attach the wheels to the metal rods on each side. Press firmly. There will be no click, but the wheels will be secured.

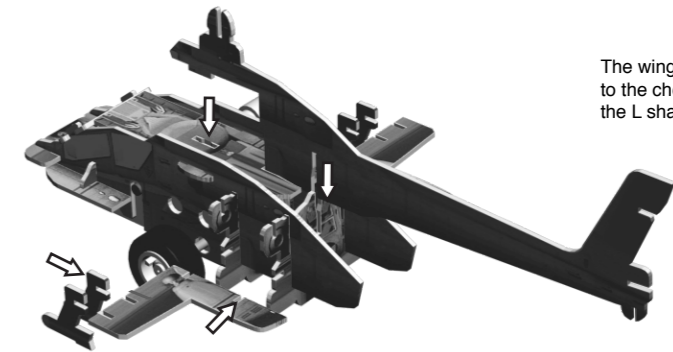

8 +H+I+J

Attach tail piece H to the chopper body. The slots correspond to the slots in pieces shown below:

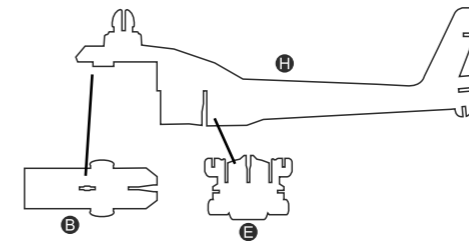

The wing pieces (I) are L-shaped. They attach to the chopper body so that the thicker side of the L shape is perpendicular to the body.

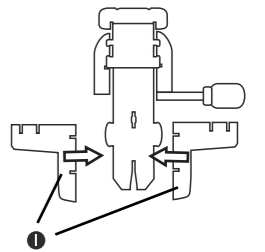

The chopper's jets (J) attach two to each wing.

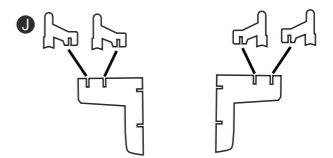

Steps 3 + 4 Side view:

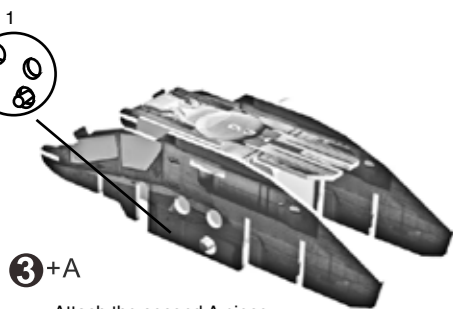
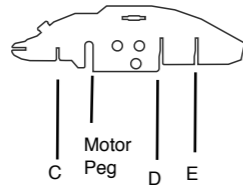

3 +A

Attach the second A piece.

Note that metal rods from the motor should poke through the third holes of each A piece. (Fig. 1)

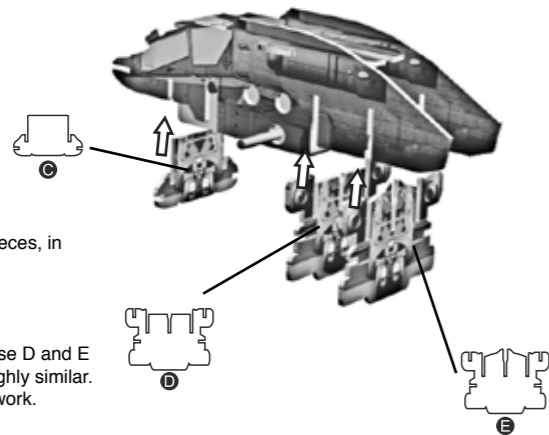

4 +C+D+E

Attach three base pieces, in order, from the front: C, D, and E.

Note: do NOT confuse D and E parts, as they are highly similar. Double-check your work.

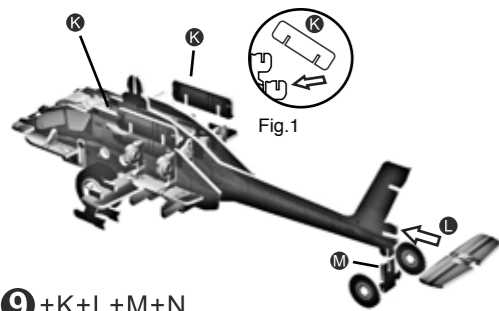

9 +K+L+M+N

Attach tail rudder L to the back slot in piece H. Attach stabilizers K to the grooves in pieces D and E from previous steps. (Fig.1)

To create the rear set of landing wheels, attach round pieces (N) onto the prongs of piece M (Fig.2). Then attach completed piece M to the rudder.

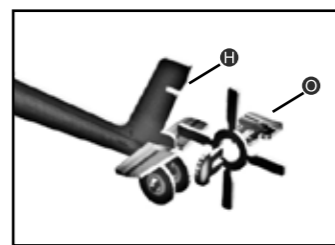
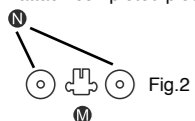

10 +O+P+Q

To create the rear propeller, attach piece O through the center of piece P. (Fig.1)

Attach this to the notch in the rear of piece H. (Fig.2). Secure it with piece Q.

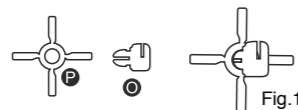
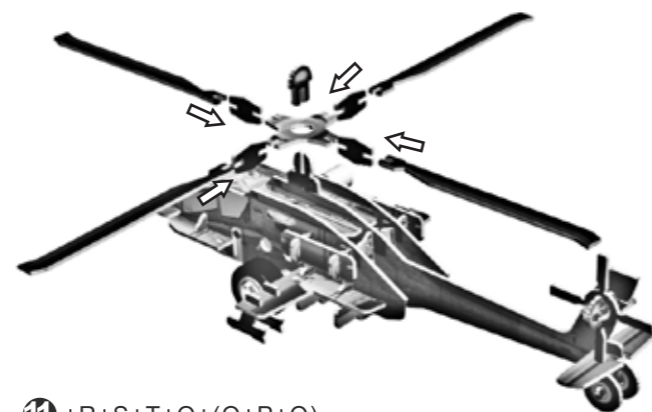
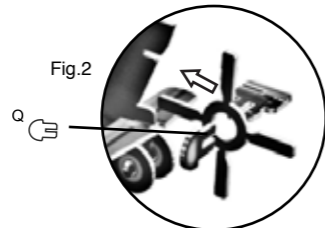
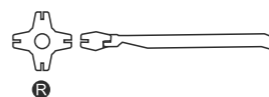

Fig.2



11 +R+S+T+Q+(O+P+Q)

To create the propeller set, attach four long T pieces to the short S connectors.



Secure each blade and connector around the propeller hub, R.

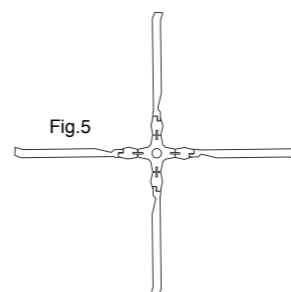
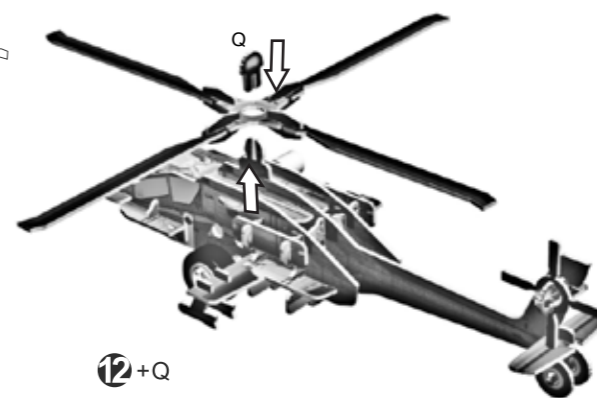

Fig.5

The completed hub should look like this. (Fig.5). Note that all propeller tips are facing the same direction.



12 +Q

Insert completed propeller set onto the H piece of the chopper. Secure it at the top with the second Q piece.



13 Wind motor.